

## ACOUSTIC PERFORMANCE

IMPACT  $L_nTW = 51dB$     AIRBORNE  $D_nTW = 56dB$      $D_nTW + CTR = 52dB$

RESULTS BASED ON HUSH-SYSTEM LC HD1036 WHICH INCORPORATES A SUSPENDED METAL CEILING

## PRODUCT DATA

COMPRISES METAL GRID SYSTEM WITH ACOUSTIC HANGERS.

A MINIMUM VOID OF 150mm SHOULD BE LEFT FROM THE UNDERSIDE OF THE JOISTS TO THE BACK OF THE PLASTERBOARD LINING.

## FEATURES

EXCELLENT ACOUSTIC PERFORMANCE.

REFURBISHMENT AND NEW BUILD.

CAN BE SUITABLE FOR SUSPENDING UP TO  $70 \text{ kg/m}^2$  IF COMPONENTS ARE USED AT THE CORRECT CENTRES.

BUILDING REGULATIONS PART E (ENGLAND & WALES), SECTION 5 (SCOTLAND) AND PART G (NORTHERN IRELAND).

EAST TO INSTALL.

CAN BE USED AS PART OF A CODE FOR SUSTAINABLE HOMES SPECIFICATION.

CAN BE USED AS A CEILING TREATMENT WITHIN ROBUST DETAILS SPECIFICATIONS.

CAN CREATE A SERVICE VOID AT CEILING LEVEL.

ECONOMICAL CEILING SOLUTION.

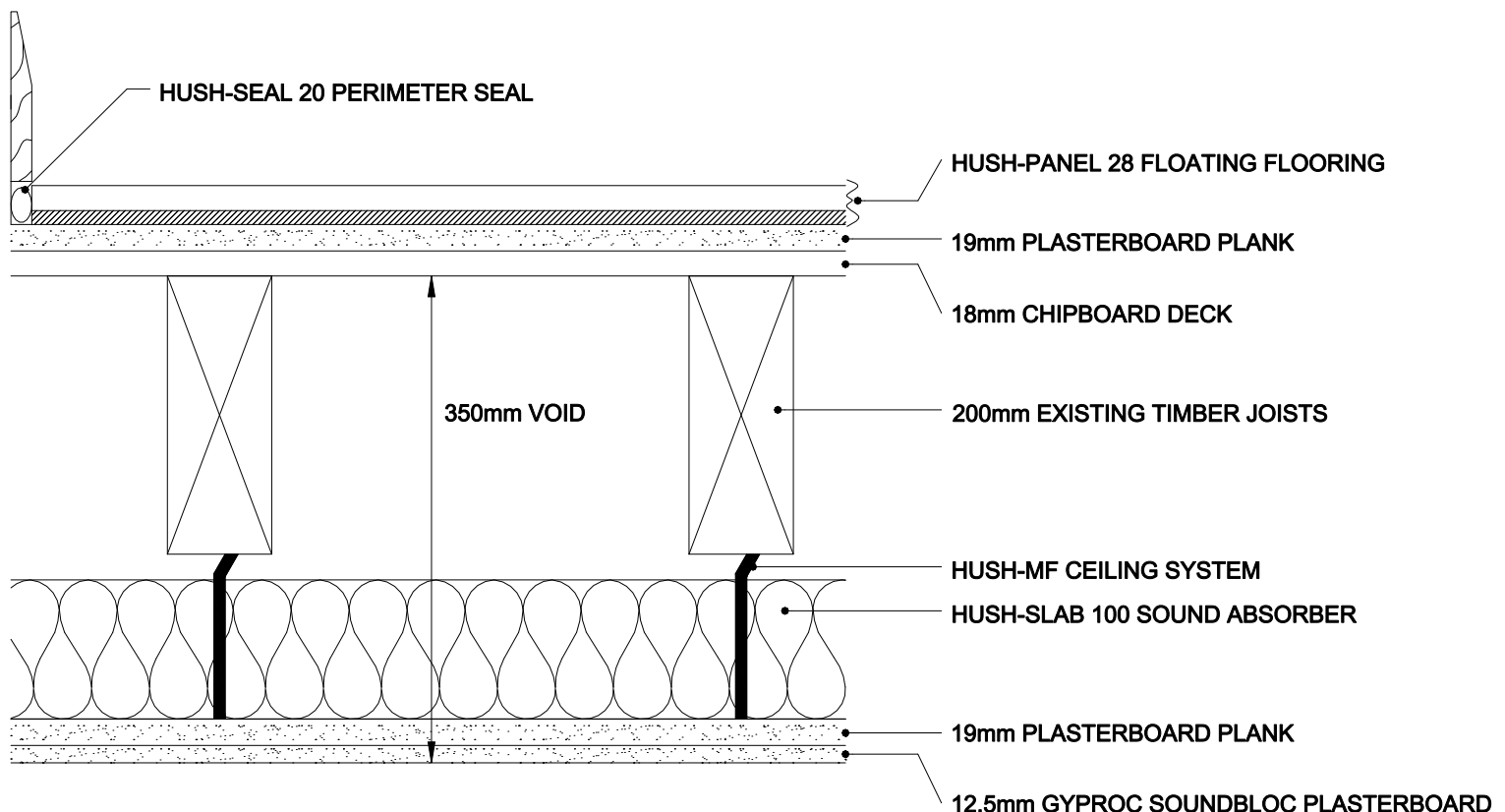

**HUSH (UK) LTD**  
**HUSH MF - SUSPENDED CEILING**